

**Installationsvejledning**  
**Montageanweisung**  
**Installation instruction**  
**Instructions d'installation**  
**Istruzioni di installazione**  
**Installatie- -instructies**  
**Instrucciones de instalación**  
**Asennusohjeet**

# damixa

Østbirkvej 2, 5240 Odense NØ, Denmark  
 Tel. +45 88 330 034  
 E-mail: damixa@fmm-mora.com  
 Homepage: www.damixa.com

05.19

20172.00

**Bell**

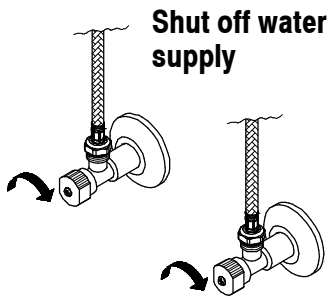
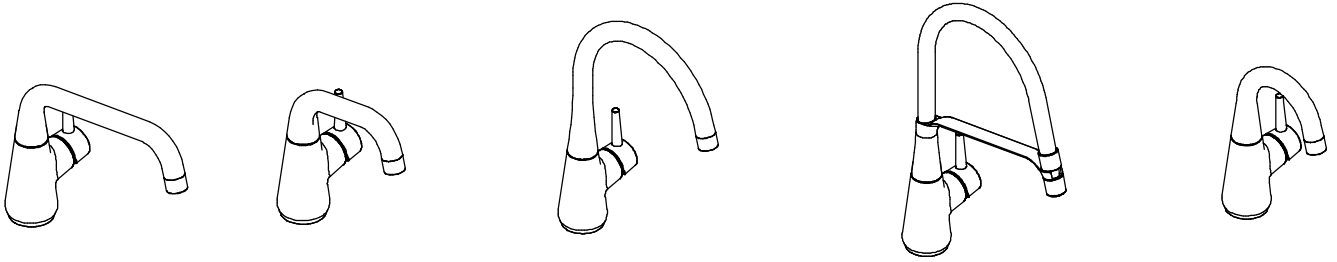

**A**

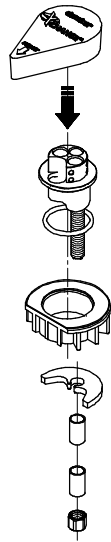

**B**

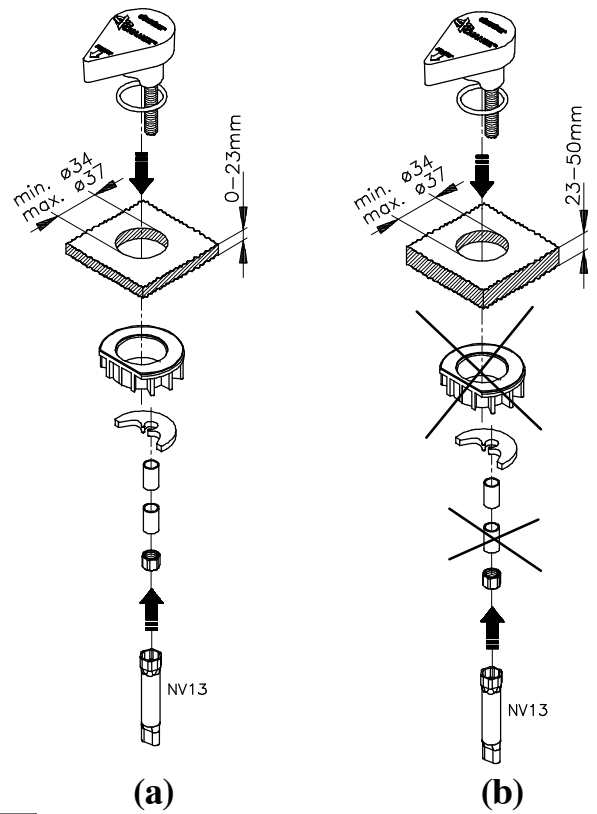

**C**

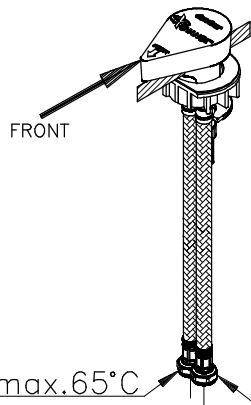

**D**

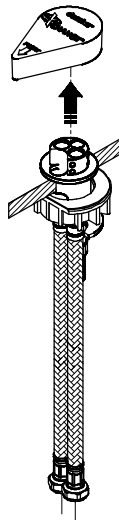

**E**

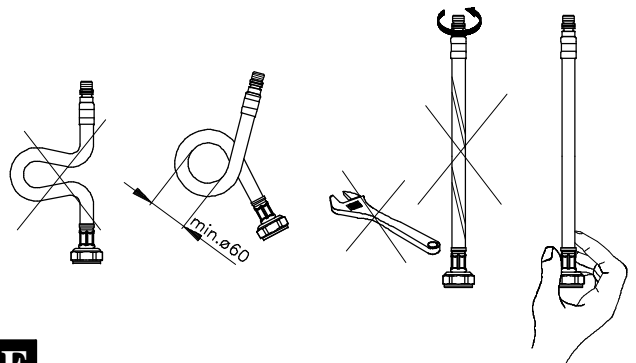

**F**

A,B:50-1000 kPa (0.5-10 bar)

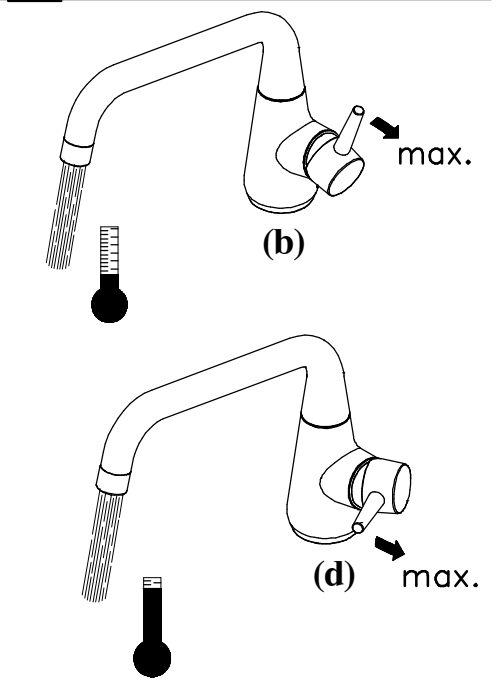
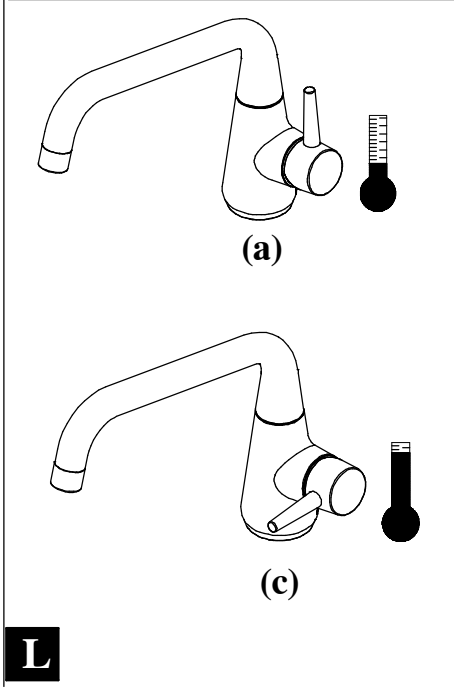
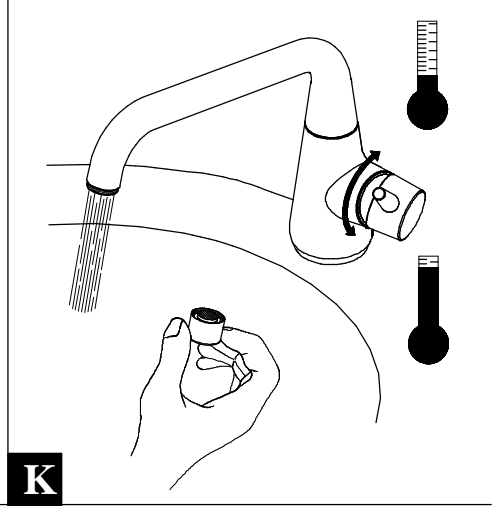
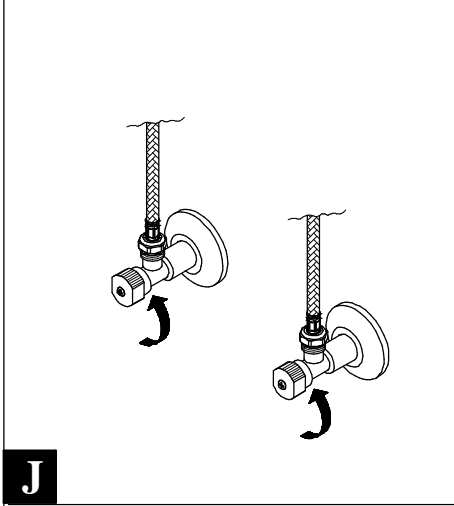
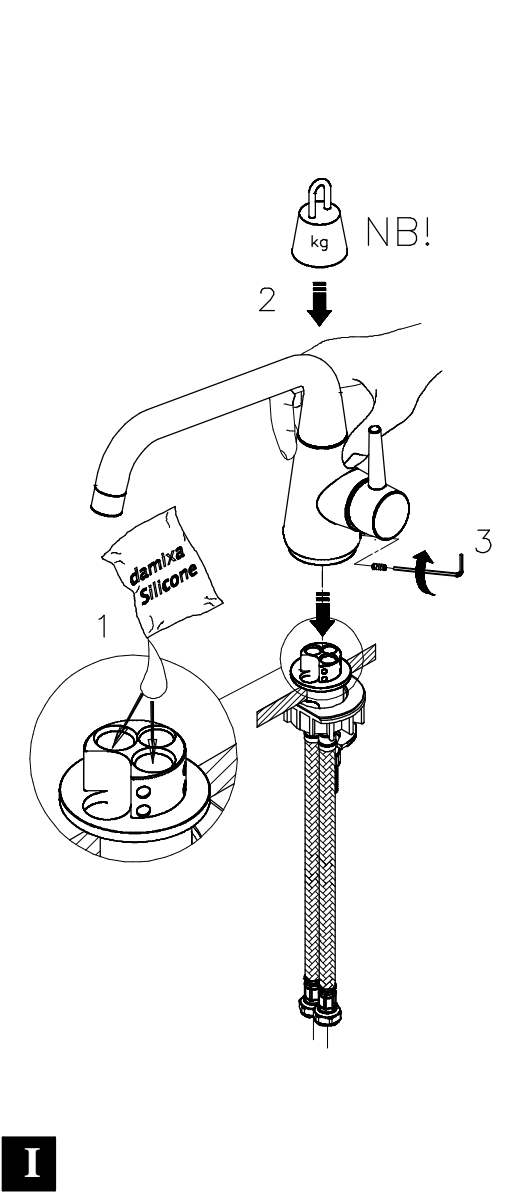
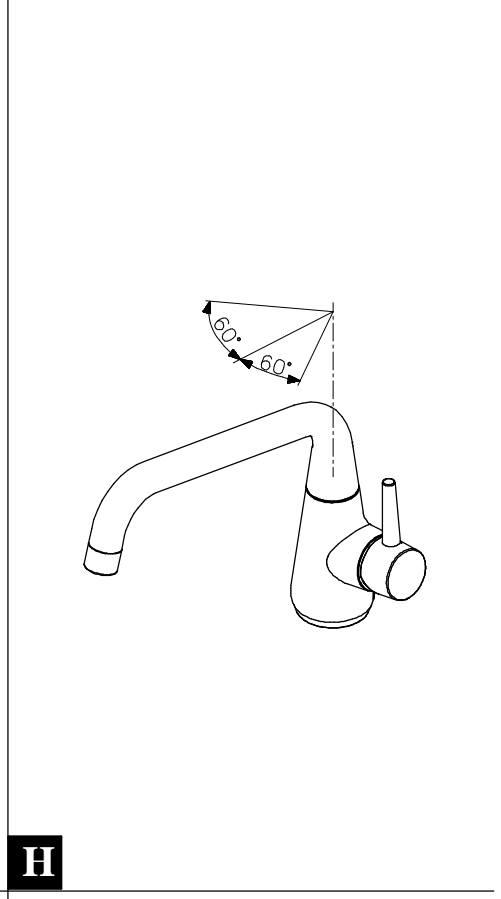
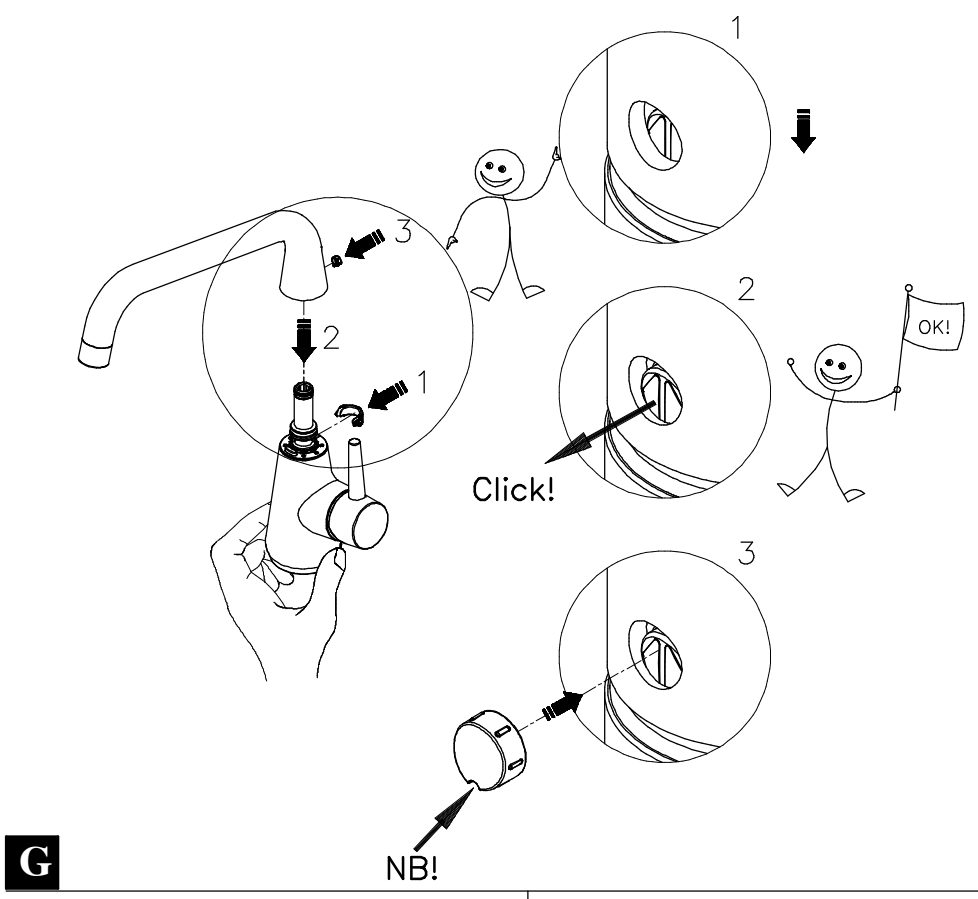

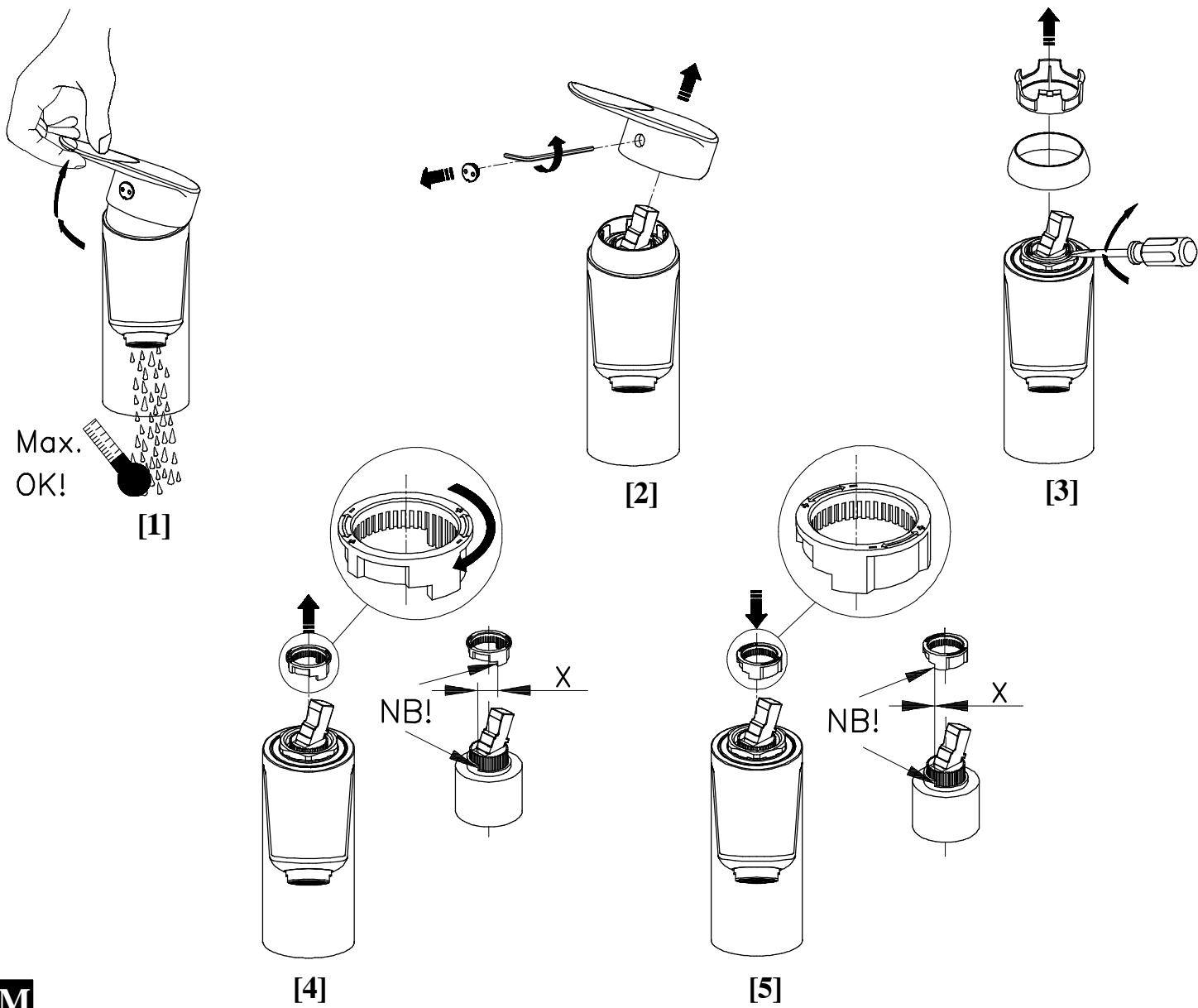

**M**

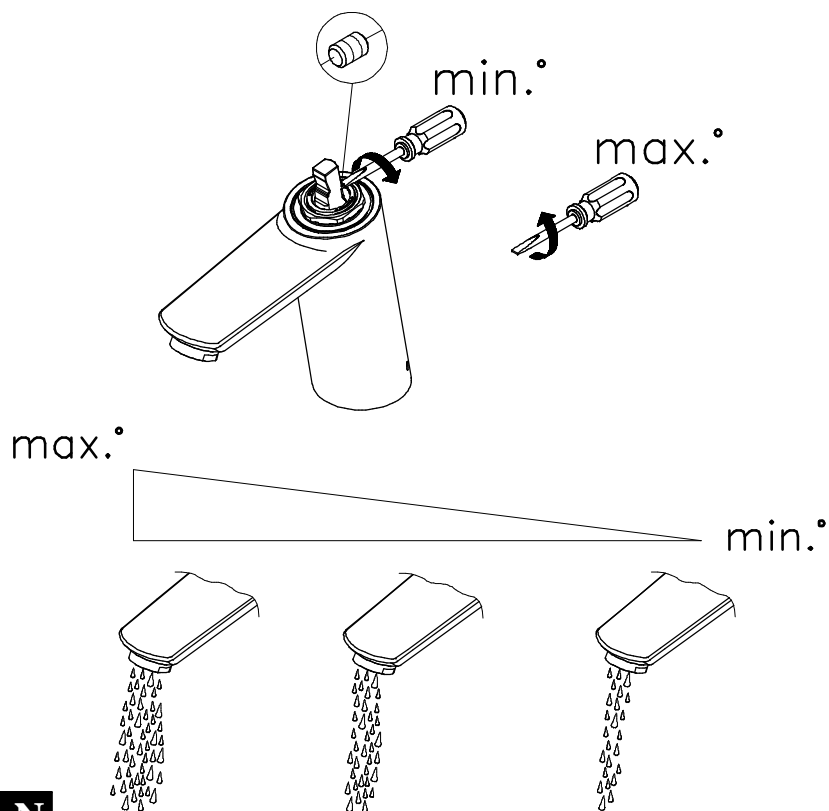

**N**

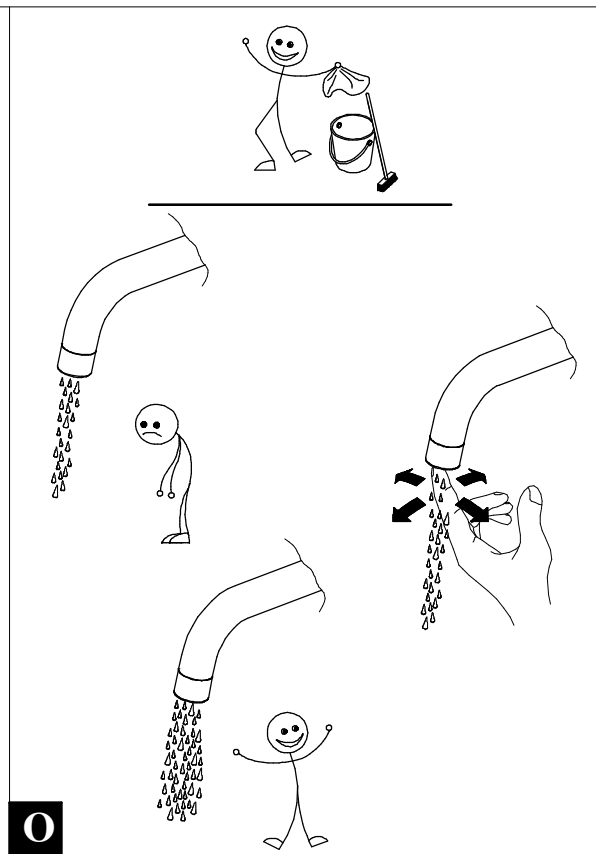

**O**

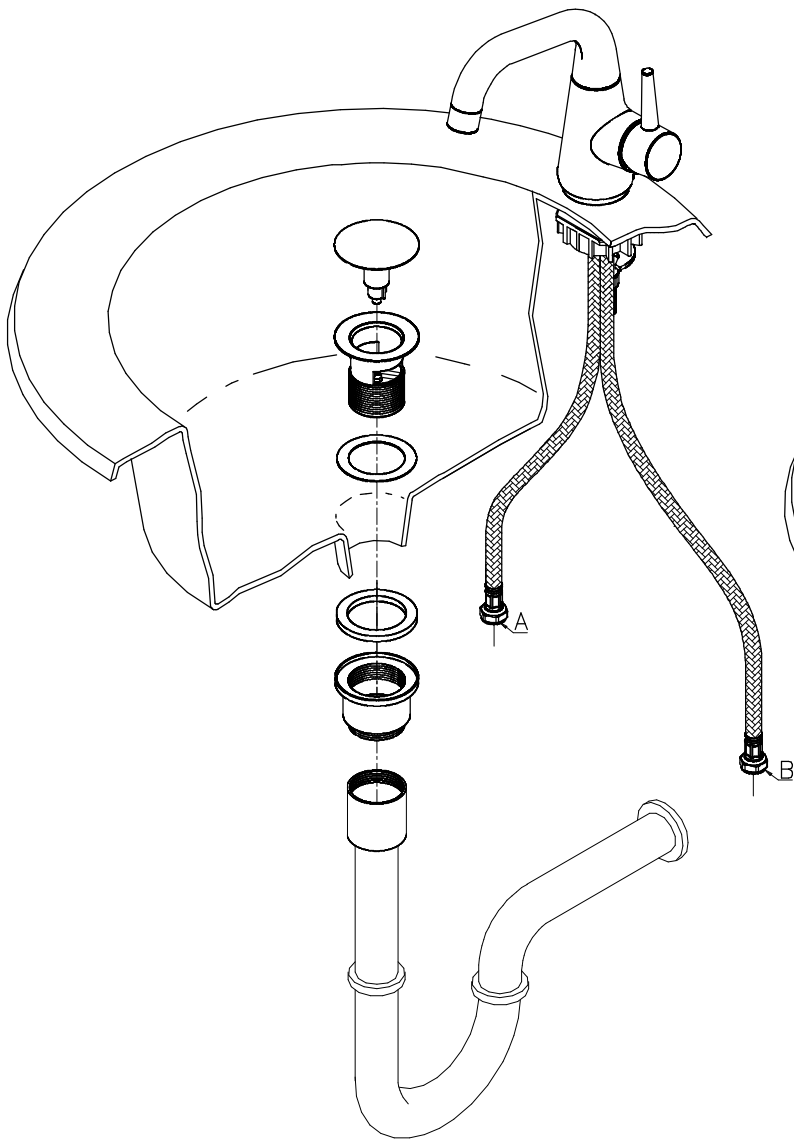

[1]

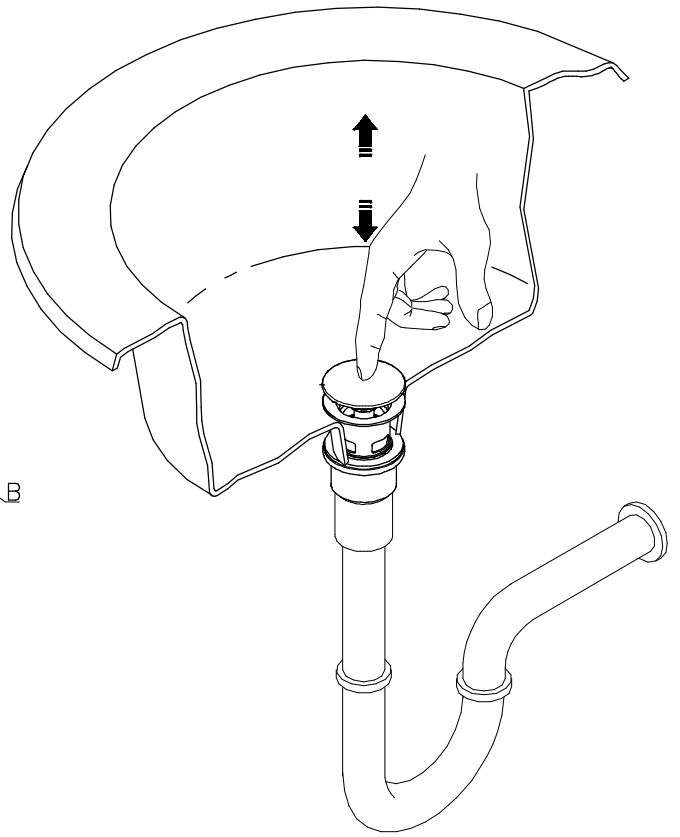

[2]

**P**

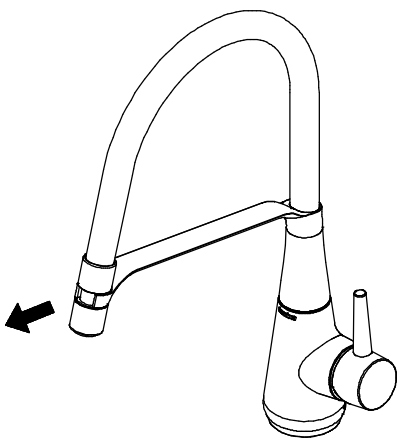

[1]

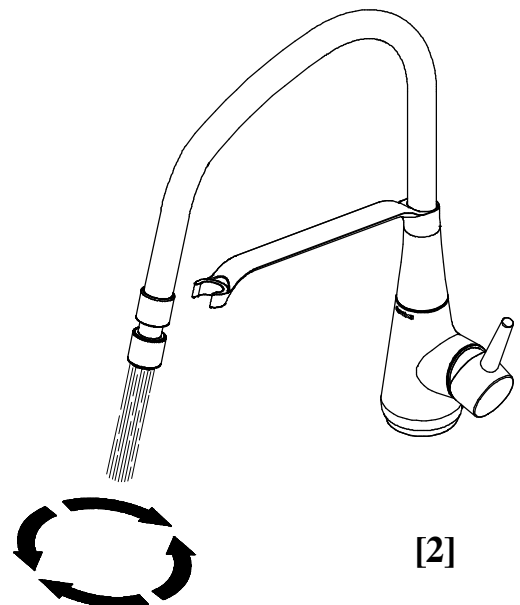

[2]

**Q**